

Flemington Borough Fire Safety  
38 Park Ave  
Flemington, NJ 08822



Phone: 908-782-8840 Ext. 227

E-mail: fireofficial@historicflemington.com

To: All Real Estate Agencies/Home Owners

Subject: Smoke Alarm/Carbon Monoxide Alarm and Portable Fire Extinguisher Inspections

Attached please find an application for a Smoke Alarm/Carbon Monoxide Alarm and Portable Fire Extinguisher Inspection which is required pursuant to the NJ Uniform Fire Code N.J.A.C. 5:70-2.3 and the Flemington Fire Safety Ordinance 8-19 when a change in occupancy or ownership occurs.

Received more than Ten (10) days before closing/change of occupancy:	\$65.00
Ten to Four (10-4) days before closing/change of occupancy:	\$100.00
Less than (4) days before closing/change of occupancy:	\$200.00

Fees can be very significant if adequate notice is not provided for these inspections.

Please note on the application, there are new fees for failed inspections and missed scheduled inspections.

ALL information on the application MUST be completed for processing. Incomplete applications may be rejected and cause a delay in inspections and certificates being issued.

Make checks payable to:  
"Flemington Boro Fire Safety"

Thank you for your cooperation in proper scheduling. Please feel free to contact our office if you should require further assistance.

Sincerely,

Ken McCormick  
Fire Marshal

# **ONE & TWO FAMILY HOMES CERTIFICATION CRITERIA FOR SMOKE ALARMS AND CO ALARMS**

## **BUILT BEFORE 1977:**

- 10 Year Sealed Battery Single Station Alarms
- One on each level
- Within 10 feet of each bedroom
- CO Alarm within 10 feet of each sleeping area

## **BUILT 1977 OR AFTER, BUT BEFORE 1984:**

- Electric Alarms not interconnected
- One on each level
- Within 10 feet of each bedroom
- CO Alarm within 10 feet of each sleeping area

## **BUILT 1984 OR AFTER, BUT BEFORE 1990:**

- Electric Alarms –INTERCONNECTED
- One on each level
- Within 10 feet of each bedroom
- CO Alarm within 10 feet of each sleeping area

## **BUILT 1990 TO PRESENT:**

- Electric Alarms with battery back-up -ALL INTERCONNECTED
- One on each level Within 10 feet of each bedroom
- In each bedroom
- CO Alarm within 10 feet of each sleeping area

Listed below are the requirements for each Certificate of Inspection:

### **SMOKE ALARMS**

- Alarms are to be located on every level of a resident (basement, first floor, second floor) excluding crawl spaces and unfinished attics, between sleeping areas such as the kitchen, garage, basement or utility room.
- In homes with only one sleeping area on one floor, an alarm is to be placed in the hallway within 10 feet of that room.
- In single family homes with two separate sleeping areas two alarms are required outside each sleeping and within 10 feet of that room.
- In multi-level homes, alarms are to be located outside sleeping areas and on every finished level of the home.
- Basement level alarms are to be located in close proximity to the bottom of the basement stairwells.
- If placed on the wall, the alarms should be four inches down from ceiling but no more than 12 inches.
- Smoke alarms shall not be older than 10 years from the date of manufacture or older than the expiration date prescribed by the manufacturer.
- Alarms are to be Installed and Maintained in accordance with NFPA 72. And shall be listed in accordance with ANSI/UL 217

### **CARBON MONOXIDE ALARMS:**

- Each alarm shall be located on the wall, ceiling or other location as specified in the installation instructions that accompany the unit.
- The alarm can either be electric, battery or the plug-in type.
- If you have a combination smoke/carbon monoxide alarm, it needs to be placed in accordance with smoke alarm placement in sleeping areas.
- Carbon monoxide alarms shall not be older than 10 years from the date of manufacture or older than the expiration date prescribed by the manufacturer.
- Carbon monoxide alarm equipment shall be installed in the immediate vicinity of each sleeping area.

### **FIRE EXTINGUISHERS**

- One fire extinguisher shall be mounted within 10 feet of the kitchen and located in the path of egress.
- The extinguisher shall be mounted using the manufacturer's mounting bracket, with the top of the extinguisher no higher than 5 feet from the floor. With the operating instructions clearly visible.
- The extinguisher shall be readily accessible and not obstructed from view.
- The extinguisher shall weigh no more than 10lbs and be a minimum 2A:10B:C rated extinguisher.
- The seller of the home shall provide proof of purchase showing that the extinguisher is less than 1 year old, or it shall be serviced and tagged by a certified Division of Fire Safety contractor within the last 12 months.
- The owner's manual or written operation instructions shall be provided during the inspection and left for the new occupant.

**In order to receive your Certificate, the location of your smoke/carbon monoxide alarms, and fire extinguisher must all be in compliance with the regulations in all codes.**

**After inspection is complete, your certification is immediately issued. Each certificate is valid for six (6) months**

## Smoke Alarm and CO Alarm placement

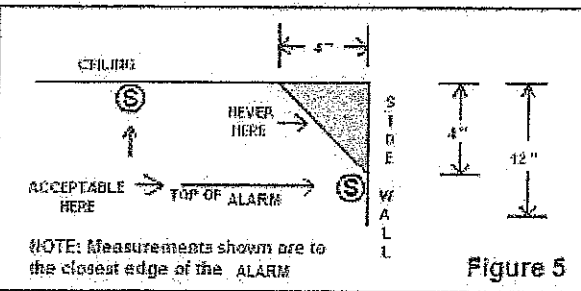
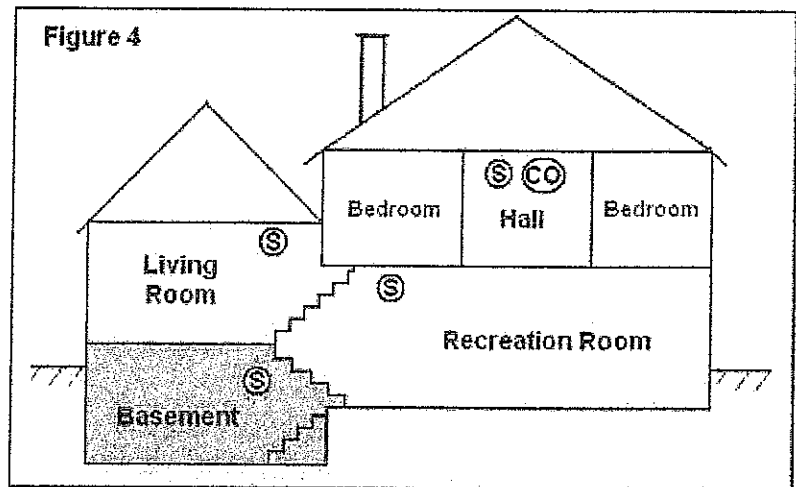
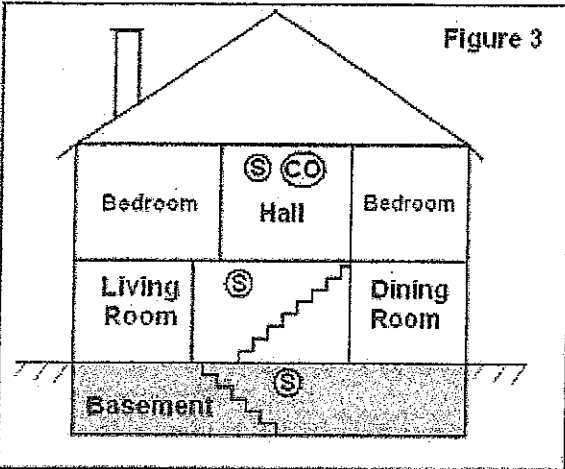
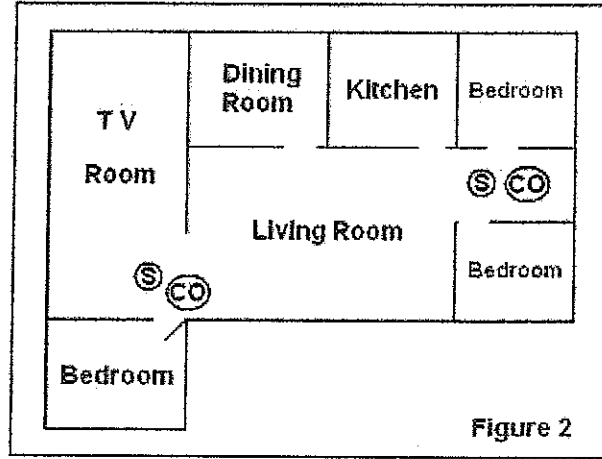
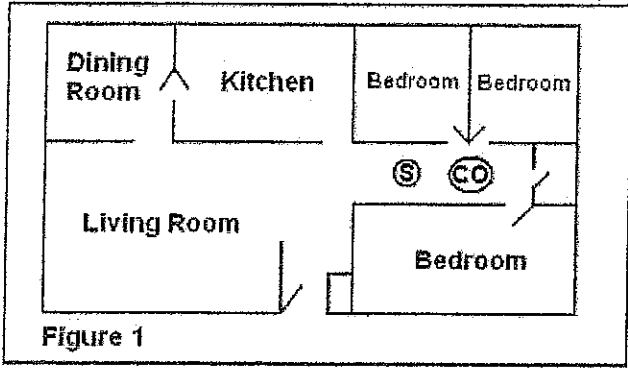

S SMOKE ALARM    
 CO CARBON MONOXIDE ALARM

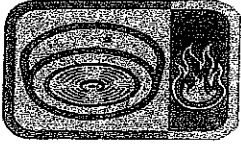

Flemington Borough Fire Safety  
 38 Park Ave  
 Flemington, NJ 08822



Phone: 908-782-8840 Ext 227

E-mail: fireofficial@historicflemington.com

N.J.A.C. 5:70-2.3 // Ordinance 8-19

Request for Certificate of Inspection Smoke & Carbon Monoxide Detector & Fire Extinguisher  
 Change of Occupancy in ALL Homes and Rental Units

Owner: \_\_\_\_\_

Block: \_\_\_\_\_ Lot: \_\_\_\_\_ Address: \_\_\_\_\_ Apt #: \_\_\_\_\_

Phone #: \_\_\_\_\_ Date of Application: \_\_\_\_\_

Date of Closing / Rental: \_\_\_\_\_

Reason: Sale      Lease      Change in occupancy

Unit Type: Single Family      Two Family      Multi Family      Townhouse  
 Condo      Apartment

Unit Class: Owner occupied      Rental property      Leased property      Bank owned      Vacant

**ALL FEES MUST BE SUBMITTED WITH APPLICATION:**

\_\_\_\_\_ \$65.00 – 10 DAYS PRIOR TO THE CLOSING

\_\_\_\_\_ \$100.00 – 10 -4 DAYS PRIOR TO THE CLOSING

\_\_\_\_\_ \$200.00 – UNDER 4 DAYS PRIOR TO THE CLOSING

Fee paid Per Inspection: \_\_\_\_\_ Check: # \_\_\_\_\_ Cash: \_\_\_\_\_ Date: \_\_\_\_\_

There will be a five hundred (\$500.00) dollar noncompliance penalty issued to anyone not applying for or getting said certification with sale of house or rental of any rental unit.

All Fees Payable to "Flemington Boro Fire Safety"

Please test all Systems Prior to inspection

**\*\*\*\* FAILED INSPECTIONS:** If a requested inspection fails, the first re-inspection is included in the initial fee. Any subsequent inspection shall be a \$30.00 for each inspection.

**\*\*\*\* FAILURE TO SHOW:** Upon a scheduled inspection, if no representative of the property shows within 10 minutes of the appointed time, there is no power if required or no access to the space, a new fee will be required for the inspection. This fee shall be that of the original fee paid for the inspection.

A SEPARATE FORM IS REQUIRED FOR EACH INSPECTION PERFORMED

# Borough of Flemington Code Enforcement

## Application for Construction Records Clearance

Application Fee (check one):             \$ 50.00 16 to 40 business days  
    \$ 80.00 6 to 15 business days  
    \$ 150.00 1 to 5 business days

Date of Closing: \_\_\_\_\_

Seller Name: \_\_\_\_\_

Mailing Address: \_\_\_\_\_

City: \_\_\_\_\_ State: \_\_\_\_\_ Zip: \_\_\_\_\_

Phone: (\_\_\_\_) \_\_\_\_\_

Property Address: \_\_\_\_\_

Block: \_\_\_\_\_ Lot \_\_\_\_\_ Qualification Code: \_\_\_\_\_

Contact Person (if agent): \_\_\_\_\_ Phone: \_\_\_\_\_

Address: \_\_\_\_\_  
\_\_\_\_\_

Call to Pick-up -or-  E-mail Address \_\_\_\_\_ (check one)

*I hereby certify that I am the (agent) owner of record and am authorized to make this application.*

\_\_\_\_\_  
Signature

\_\_\_\_\_  
Date

---

### OFFICE USE ONLY

Received Date \_\_\_\_\_ Check # \_\_\_\_\_ Cash \_\_\_\_\_

Open Permits Yes or No If Yes, permit #'s \_\_\_\_\_ / \_\_\_\_\_ / \_\_\_\_\_

All CO or CA issued Y or N

CRC issue date: \_\_\_\_\_

CRC Certificate # \_\_\_\_\_ (attach copy)



Borough of Flemington  
Department of Wastewater Collections

38 Park Avenue  
Flemington, New Jersey 08822  
Phone (908) 782-8578  
Fax (908) 782-1718  
Hours of Operation  
Monday - Friday 7:00AM - 3:30PM  
Holidays excluded

Inspection Application for Sanitary Sewer Ordinance 2005-18

Property Owner _____	Block _____	Lot _____
Contact Person: _____	Phone Number: _____	
Closing Date: _____		

Dwelling to be Inspected Address: _____
---

Building Type: check one	Single Family _____	Multi-Family _____
	Commercial _____	Professional _____

**Note:**

Non-owner occupied residential, commercial, and 5 or more unit dwellings are inspected once every two years. They do not need an inspection for resale unless the inspection has not been completed in the last two years.

**Note:**

Please submit a check or money order in the amount of \$25.00 made payable to the Flemington Borough Sewer Department with the completion of this form.

Do not combine the sump pump inspection fee with the smoke detector inspection fee.

When this form is completed and returned to the Flemington Borough Hall, you will be contacted to arrange an appointment. Please allow 2 weeks prior to the closing date to set up an inspection. If you have any questions prior to the inspection you may contact the sewer department at (908) 782-8578.

Applicant Signature: \_\_\_\_\_

Payment _____	Check # _____	Cash _____
---------------	---------------	------------

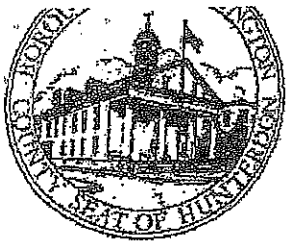

## Borough of Flemington Water Department

38 Park Avenue

Flemington, New Jersey 08822

Hours of Operation

Monday - Friday 7:00AM - 3:30PM

Holidays excluded

### Inspection Application for Water Utility Ordinance 2008-6

Property Owner _____	Block _____	Lot _____
Contact Person: _____	Phone Number: _____	
Closing Date: _____		

Dwelling to be Inspected Address: _____
---

Building Type: check one	Single Family _____	Multi-Family _____
	Commercial _____	Professional _____

#### **Note:**

Please submit a check or money order in the amount of \$30.00 made payable to the Flemington Borough Water Department with the completion of this form.

Do not combine the water meter inspection fee with the smoke detector or sump pump inspection fee.

When this form is completed and returned to the Flemington Borough Hall, you will be contacted to arrange an appointment. Please allow 2 weeks prior to the closing date to set up an inspection. If you have any questions prior to the inspection you may contact the water department at (908) 782-8840 Ext. 222.

Applicant Signature: \_\_\_\_\_

Payment _____	Check # _____	Cash _____
---------------	---------------	------------